

Teitzel Building

North Bonneville, WA

A Mixed-Use Industrial Property Offered by Port of Skamania County



Building: Insulated steel and concrete panel tilt-up construction, three manway doors, one 12' X 12' high-bay rollup door, truck-height loading dock

Space: 8,325 square feet of high-bay space, ~3,000 square feet of optional mezzanine, one bathroom

Lease Rate: negotiable based on number of "family wage" jobs created and overall benefit to the economy

Utilities: City sewer, water, and cable TV, 3-phase power (PUD), gas, telephone

Transportation: 30 miles to Portland International Airport, 40 miles to Portland, 35 miles to Vancouver, 5 miles to I-84

Zoning: Industrial

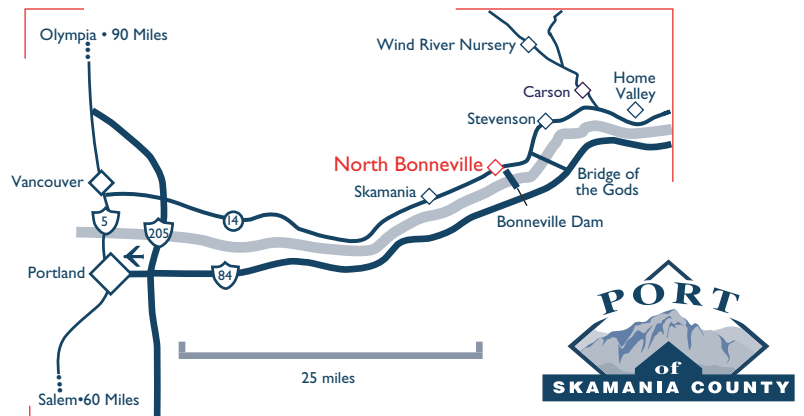
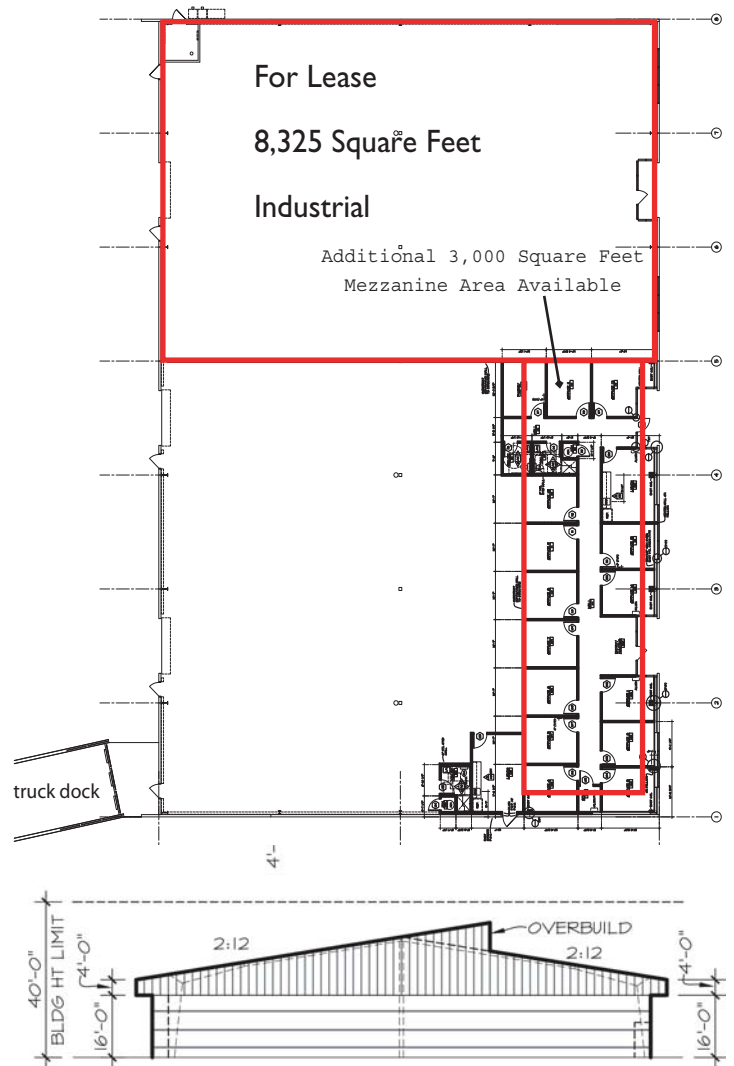

Directions to Property: From Portland take I-84 east to the Bridge of the Gods exit #44; Cross bridge to Washington SR 14, west 3 miles past North Bonneville, 1st right past railroad overpass on Evergreen Drive. The Teitzel Building is on the right at 390 Evergreen Drive.

509.427.5484 • www.portofskamania.org
PO Box 1099 • Stevenson, WA 98648